



Temperatursætt 60/40/20  
DELTA T<sub>e</sub>40





# LAVKONVEKTORER



**ISAN**  
RADIATORER

# 1 K21

= Lagervarer

Lgd/mm	Hd/mm	70	140	210	280
400	Watt:	60	85	108	130
500	Watt:	75	106	136	162
600	Watt:	89	127	162	195
700	Watt:	104	149	190	227
800	Watt:	119	169	217	260
900	Watt:	134	191	243	292
1000	Watt:	149	212	271	325
1100	Watt:	163	233	298	357
1200	Watt:	178	255	325	390
1400	Watt:	208	297	379	455
1500	Watt:	223	318	406	487
1600	Watt:	237	339	433	520
1800	Watt:	267	381	487	585
2000	Watt:	297	424	541	650
2200	Watt:	327	467	595	714
2400	Watt:	357	509	650	779
2600	Watt:	386	551	704	845
2800	Watt:	401	593	758	910
3000	Watt:	446	636	812	974
3200	Watt:	475	679	866	1039
3400	Watt:	505	721	920	1104
3600	Watt:	534	763	974	1169
3800	Watt:	564	805	1029	1234
4000	Watt:	594	848	1083	1299
					
6000	Watt:	891	1272	1624	1949

## Temperatursæt 60/40/20

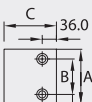
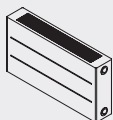

A	70	140	210	280
B	0	90	160	230
C	72			





Alle tal er mm

Anbringer: 4 x 1/2"  
 Farve: RAL 9016  
 Max. driftstryk: 6 bar.  
 Prøvetryk: 7,5 bar.

NB: Leveringstid på lavkonvektorer ud over lagerprogram er ca. 6 uger

# K32

= Lagervarer **2**

Lgd/mm	Hd/mm	70	140	210	280
400	Watt:	98	143	184	222
500	Watt:	122	179	230	278
600	Watt:	147	214	276	333
700	Watt:	171	250	323	388
800	Watt:	196	286	368	444
900	Watt:	220	322	414	499
1000	Watt:	245	357	460	555
1100	Watt:	269	393	507	610
1200	Watt:	294	429	553	666
1400	Watt:	343	500	645	776
1500	Watt:	367	536	691	832
1600	Watt:	392	571	737	888
1800	Watt:	440	643	829	998
2000	Watt:	489	714	921	1109
2200	Watt:	538	786	1013	1220
2400	Watt:	587	857	1105	1331
2600	Watt:	636	929	1197	1442
2800	Watt:	685	1000	1289	1553
3000	Watt:	734	1072	1381	1664
3200	Watt:	783	1143	1474	1775
3400	Watt:	832	1215	1566	1886
3600	Watt:	881	1286	1658	1997
3800	Watt:	930	1357	1750	2108
4000	Watt:	979	1429	1842	2219
					
6000	Watt:	1468	2143	2763	3328

## Temperatursæt 60/40/20

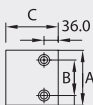
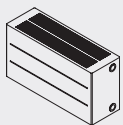

A	70	140	210	280
B	0	90	160	230
C	133			

Alle tal er mm

Anbringer: 4 x 1/2"  
 Farve: RAL 9016  
 Max. driftstryk: 6 bar.  
 Prøvetryk: 7,5 bar.

Alle priser er bruttopriser ex. moms. Ret til ændringer forbeholdes.

# 3 K43

= Lagervarer

Lgd/mm	Hd/mm	70	140	210	280
400	Watt:	136	201	260	314
500	Watt:	170	251	325	393
600	Watt:	204	301	390	471
700	Watt:	238	352	455	550
800	Watt:	272	402	520	628
900	Watt:	306	452	586	707
1000	Watt:	340	502	651	785
1100	Watt:	375	552	715	864
1200	Watt:	408	603	781	943
1400	Watt:	476	703	911	1100
1500	Watt:	511	753	976	1178
1600	Watt:	544	803	1041	1256
1800	Watt:	612	904	1171	1414
2000	Watt:	680	1005	1301	1571
2200	Watt:	749	1105	1431	1728
2400	Watt:	817	1206	1561	1885
2600	Watt:	885	1306	1691	2042
2800	Watt:	953	1406	1821	2199
3000	Watt:	1021	1507	1952	2356
3200	Watt:	1089	1607	2082	2513
3400	Watt:	1157	1708	2212	2671
3600	Watt:	1225	1808	2342	2827
3800	Watt:	1293	1909	2472	2984
4000	Watt:	1361	2009	2602	3142
6000	Watt:	2041	3014	3903	4712

## Temperatursæt 60/40/20

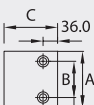
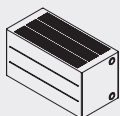

A	70	140	210	280
B	0	90	160	230
C	194			





Alle tal er mm

Anboringer: 4 x 1/2"  
 Farve: RAL 9016  
 Max. driftstryk: 6 bar.  
 Prøvetryk: 7,5 bar.

Alle priser er bruttopriser ex. moms. Ret til ændringer forbeholdes.

# K54

 = Lagervarer 4

Lgd/mm	Hd/mm	70	140	210	280
400	Watt:	170	256	332	401
500	Watt:	213	320	415	502
600	Watt:	256	383	497	602
700	Watt:	298	447	580	702
800	Watt:	341	511	663	802
900	Watt:	384	575	746	903
1000	Watt:	426	639	829	1003
1100	Watt:	469	703	912	1103
1200	Watt:	512	767	995	1203
1400	Watt:	597	895	1161	1404
1500	Watt:	640	959	1244	1504
1600	Watt:	682	1023	1326	1604
1800	Watt:	767	1150	1492	1805
2000	Watt:	852	1278	1658	2005
2200	Watt:	938	1406	1824	2206
2400	Watt:	1023	1534	1990	2406
2600	Watt:	1108	1662	2155	2607
2800	Watt:	1193	1790	2321	2807
3000	Watt:	1279	1917	2487	3008
3200	Watt:	1364	2045	2652	3209
3400	Watt:	1449	2173	2819	3409
3600	Watt:	1534	2301	2984	3610
3800	Watt:	1619	2429	3150	3810
4000	Watt:	1705	2556	3316	4011
					
6000	Watt:	2557	3835	4974	6016

## Temperatursæt 60/40/20

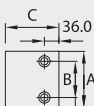
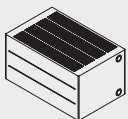

A	70	140	210	280
B	0	90	160	230
C	255			
Alle tal er mm				

Anboringer:	4 x 1/2"
Farve:	RAL 9016
Max. driftstryk:	6 bar.
Prøvetryk:	7,5 bar.

NB: Leveringstid på lavkonvektorer ud over lagerprogram er ca. 6 uger



## VÆGBÆRING

Standard vægbæring

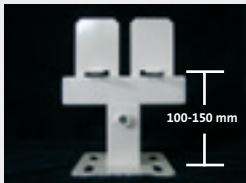

## GULVBEN

Standard gulvben  
(100-150 mm)  
Extra lang gulvben  
(300 mm)

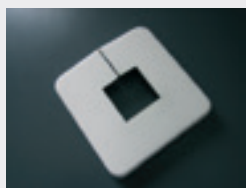

## ROSETTE

Rosette til gulvben

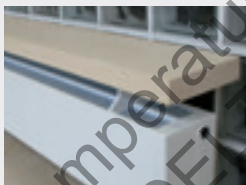

## HYLDEKNÆGT



## INTEGRERET VENTIL

Samtlige lavkonvektorer fås med integreret ventil, undtagen højde 70mm. Ventilindsatsen er en Heimeier indsats som standard. Danfoss ventilindsats RA-N med forindstilling kan også fås. Dette skal blot nævnes ved bestilling. Merpris pr. lavkonvektor

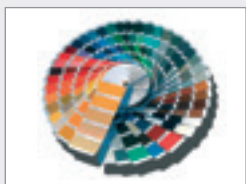

## FARVER

Standardfarve i hvid RAL 9016. Lavkonvektorerne kan bestilles i forskellige RAL-nuancer. Merprisen pr. lavkonvektor er afhængig af hvilken farve, der vælges.

**Merpris 10-30 %**



**Oventrop - ventiler - 1/2\"**  
**AV9 forindst. - M30 x 1 1/2\"**

O1183704 - vinkel pr. stk.  
O1183804 - lige pr. stk.  
O1183904 - omv. Vinkell. pr. stk.



**Oventrop - ventiler - 1/2\"**  
**uden forindst. - stort flow - M30 x 1 1/2\"**

O1181004 - vinkel pr. stk.  
O1181104 - lige pr. stk.  
O1181404 - omv. Vinkell. pr. stk.



**Oventrop - føler M30 x 1 1/2\"**

O1011465 - Uni LH pr. stk.  
O1013066 - Vindo TH pr. stk.



**Danfoss ventil RA-N - 1/2\"**

40 3202 004 - lige pr. stk.  
40 3204 004 - vinkel pr. stk.  
40 3205 004 - omv. Vinkell. pr. stk.



**Danfoss ventil RA-G - 1-strengs - 1/2\"**

40 3282 104 - lige pr. stk.  
40 3283 104 - vinkel pr. stk.



**Danfoss - føler snap**

RA 2990 - 40 3222 100 pr. stk.



**Oventrop - føler t/ danfoss snap ventiler**

O1011475 - Uni LD pr. stk.  
O1013076 - Vindo LD pr. stk.



**Fjernfølere**

Danfoss RA 2992  
40 3224 100 pr. stk.



Oventrop LH - 2mt. - M30 x 1 1/2\"  
O1011665 pr. stk.



Oventrop FH - termostat med fjernbetj. - 2 mtr.  
O1012295 pr. stk.



MH CON - telestat m/batteri\"  
O1150665 pr. stk.

R Tronic - rumføler m/display  
O1150680 pr. stk.

Temperatursæt 60/40/20  
DELTA T=40

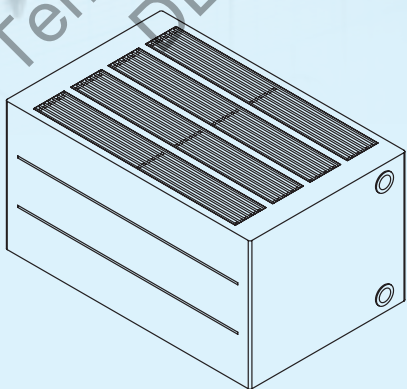

**RADIATORER**

# TEKNISKE TEGNINGER



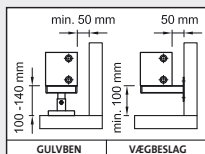
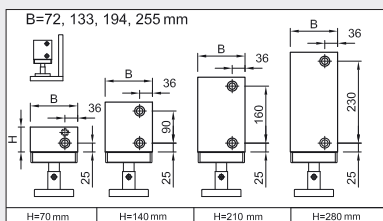
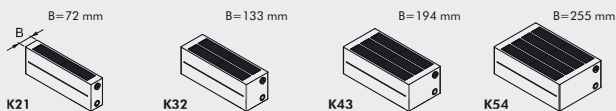

## TILSLUTNINGER

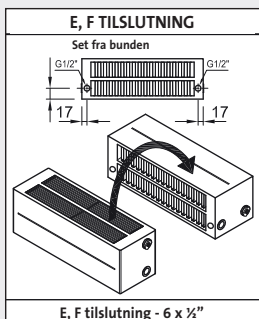
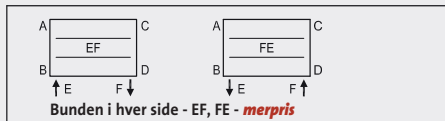
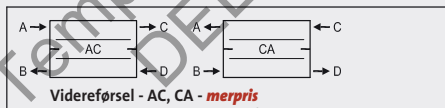
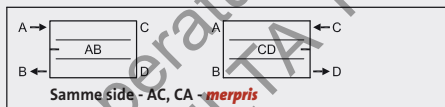
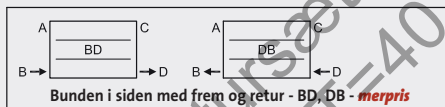
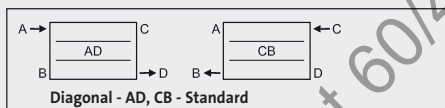

**Merpris** for andre tilslutninger end standard

# 42 VENTILSYSTEM

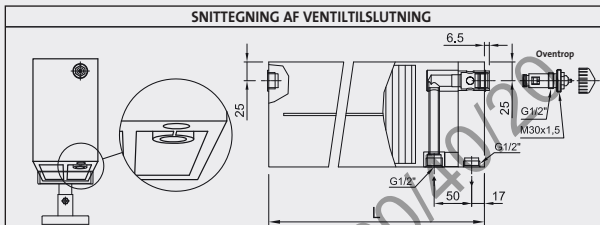
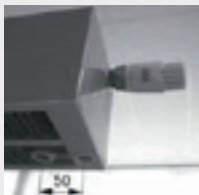
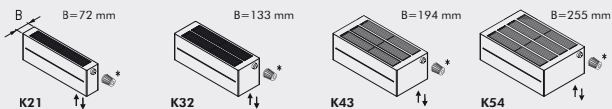

Ventilsystem – *merpris*

## MIDTERTILSLUTNING

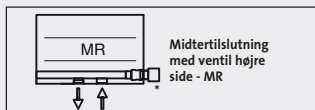
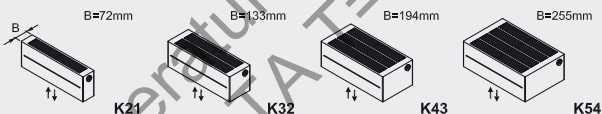

Midtertilslutning med ventil – *merpris* pr. konvektor